

CDR

S. G. No.
Approved
for
Surveyor-general

GENERAL PLAN No. OF SUBDIVISIONS OF ERF 8964 EERSTE RIVER

Vide Dgm. SG. No. annexed to D/T and comprising 60 Erven, 2 Public Places and the streets Situate in the Administrative District of Cape Province of the Western Cape

Scale 1: 500

ENDORSEMENTS				
No.	AMENDMENT	ADDITION	AUTHORITY	INTD. DATE

MAIN FIGURE			
SIDES METRES	ANGLES OF DIRECTION	CO-ORDINATES Y System: WG 19 th X	
AB	145.24	241 18 10	A +24 488,81 +3 766 180,46
BC	86.70	302 52 00	B +24 361,41 +3 766 110,73
CD	20.00	32 52 00	C +24 288,59 +3 766 157,77
DE	13.44	18 03 40	D +24 299,44 +3 766 174,58
EF	79.72	32 51 50	E +24 303,61 +3 766 187,36
FG	26.23	61 15 00	F +24 346,87 +3 766 254,32
GH	56.25	331 23 00	G +24 369,87 +3 766 266,93
HI	26.00	61 14 50	H +24 342,92 +3 766 316,31
JK	12.72	80 46 10	J +24 365,72 +3 766 328,82
KL	25.00	61 15 00	K +24 378,27 +3 766 330,86
LA	185.02	151 23 00	L +24 400,19 +3 766 342,88

BLOCK CORNERS		AREAS	
A1	A2	ERF NUMBER	SQUARE METRES
A1	+24 426,74	+3 766 146,49	8757
A2	+24 416,16	+3 766 154,11	8758
A3	+24 412,73	+3 766 167,91	8759
A4	+24 414,02	+3 766 171,80	8760
A5	+24 475,29	+3 766 205,25	8761
B1	+24 394,01	+3 766 128,57	8762
B2	+24 388,89	+3 766 132,26	8763
B3	+24 340,82	+3 766 163,32	8764
B4	+24 339,63	+3 766 168,85	8765
B5	+24 377,82	+3 766 227,95	8766
B6	+24 409,98	+3 766 245,60	8767
B7	+24 414,04	+3 766 244,43	8768
B8	+24 439,30	+3 766 196,13	8769
B9	+24 438,10	+3 766 194,06	8770
B10	+24 404,84	+3 766 175,91	8771
B11	+24 402,32	+3 766 168,30	8772
B12	+24 407,34	+3 766 148,14	8773
B13	+24 417,02	+3 766 141,17	8774
C1	+24 381,37	+3 766 121,65	8775
D1	+24 322,18	+3 766 171,71	8776
D2	+24 328,71	+3 766 175,90	8777
D3	+24 368,68	+3 766 237,77	8778
D4	+24 402,88	+3 766 256,53	8779
D5	+24 404,46	+3 766 261,98	8780
D6	+24 394,41	+3 766 280,40	8781
D7	+24 392,66	+3 766 279,44	8782
E1	+24 382,08	+3 766 323,88	8783
E2	+24 386,15	+3 766 322,49	8784
E3	+24 405,46	+3 766 333,23	8785
F1	+24 410,24	+3 766 324,46	8786
F2	+24 390,94	+3 766 313,91	8787
F3	+24 389,74	+3 766 309,84	8788
F4	+24 413,24	+3 766 266,77	8789
F5	+24 418,66	+3 766 265,19	8790
F6	+24 437,07	+3 766 275,29	8791
G1	+24 443,29	+3 766 263,89	8792
G2	+24 424,01	+3 766 253,29	8793
G3	+24 422,82	+3 766 249,22	8794
G4	+24 448,08	+3 766 202,92	8795
G5	+24 452,15	+3 766 201,72	8796
G6	+24 471,45	+3 766 212,27	8797
TOWN SURVEY MARKS			
0,00	0,00	8798	287
0,00	0,00	8799	232
		8800	224
		8801	263
		8802	263
		8803	263
		8804	299
		8805	299
		8806	299
		8807	270
		8808	271
		8809	275
		8810	275
		8811	288
		8812	280
		8813	271
		8814	250
		8815	250
		8816	250
		8817	219
		8818	221
Total 17901			

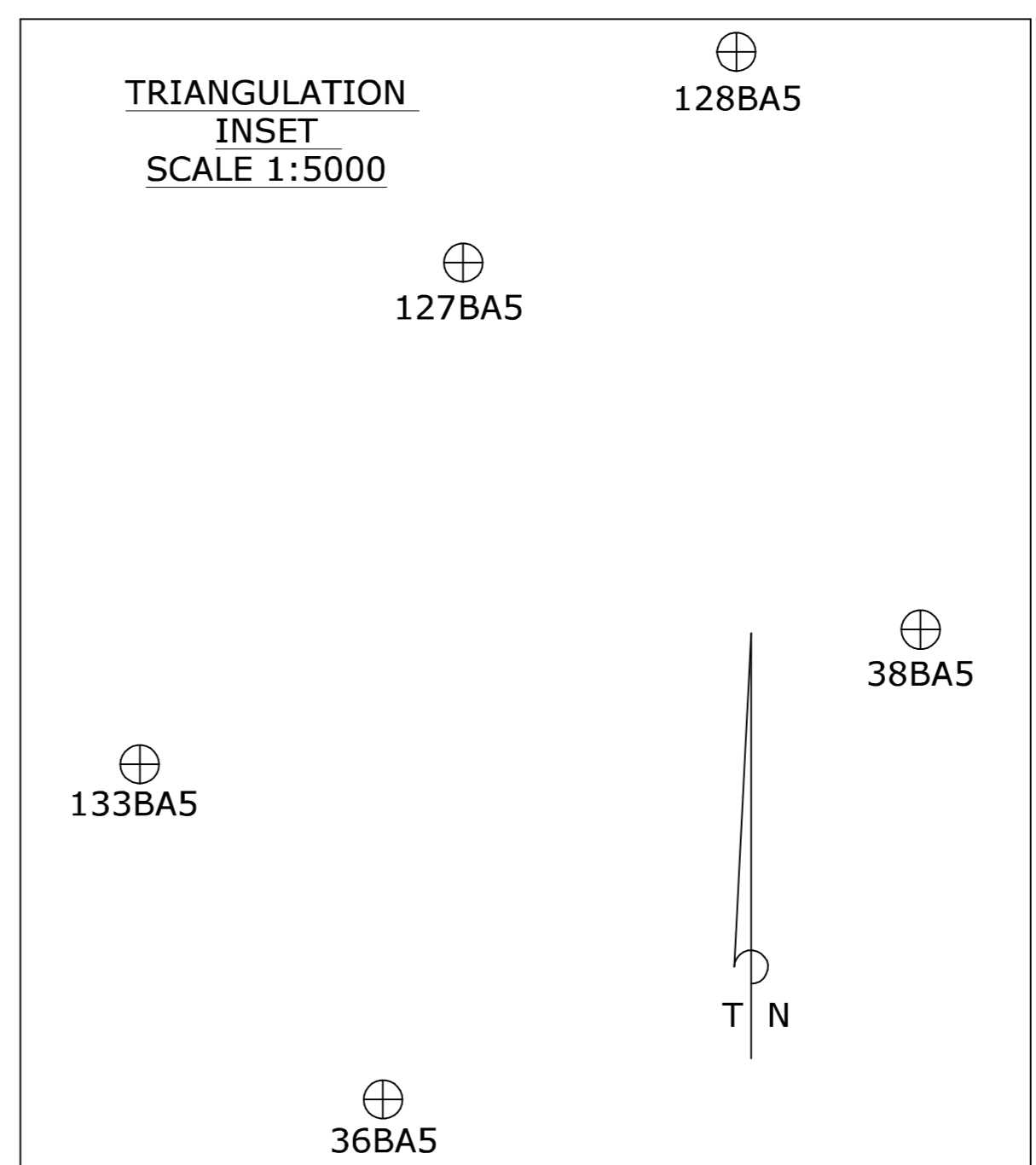

THIS GENERAL PLAN WAS FRAMED BY ME AND I UNDERTAKE TO PLACE THE BEACONS OF THE ERVEN IN POSITIONS WHICH CORRESPOND WITH THE DATA ON THIS PLAN AND TO SUBMIT THE FINAL GENERAL PLAN AND THE SURVEY RECORDS PERTAINING THERETO WITHIN THE PRESCRIBED PERIOD TO THE SURVEYOR - GENERAL FOR APPROVAL

D. H. BATES
PROFESSIONAL LAND SURVEYOR
P.L.S. No. 0035
FEBRUARY 2012

S.R. No.
Comp. AHND-2191 (M1766)
AHND-2193 (M4507)
File No. S/8989/24